

ITEM	PART NUMBER	DESCRIPTION	QTY.	
		Electrical — Leveling Option — Installation Model 15		
Ref.	159-1078-914	Electrical - Leveling Option - Installation		
1.	159-1078-445	Leveling Harness	1	
2.	BS-2500-005	Sik-A-Flex, Black	AR	
3.	BS-5503-242	Bushing, Snap 1" I.D. .125" THK	1	
4.	BS-4532-001	Tie-Wrap 7.43" Lg.	AR	
5.	BS-5503-250	Bushing Snap 1.96" I.D. .250 THK	1	
6.	159-1078-918	R.H. Dash Upper Tray Modification (I.P.B. 16-220-MHO)	REF	
7.	159-1419-049	Angle, Control Panel Support	1	
8.	159-1701-152	Center Panel, Drivers Floor	1	
9.	154-1002-408	Electrical Schematic Board-Leveling System	1	
10.	BS-4427-002	Rivet	4	

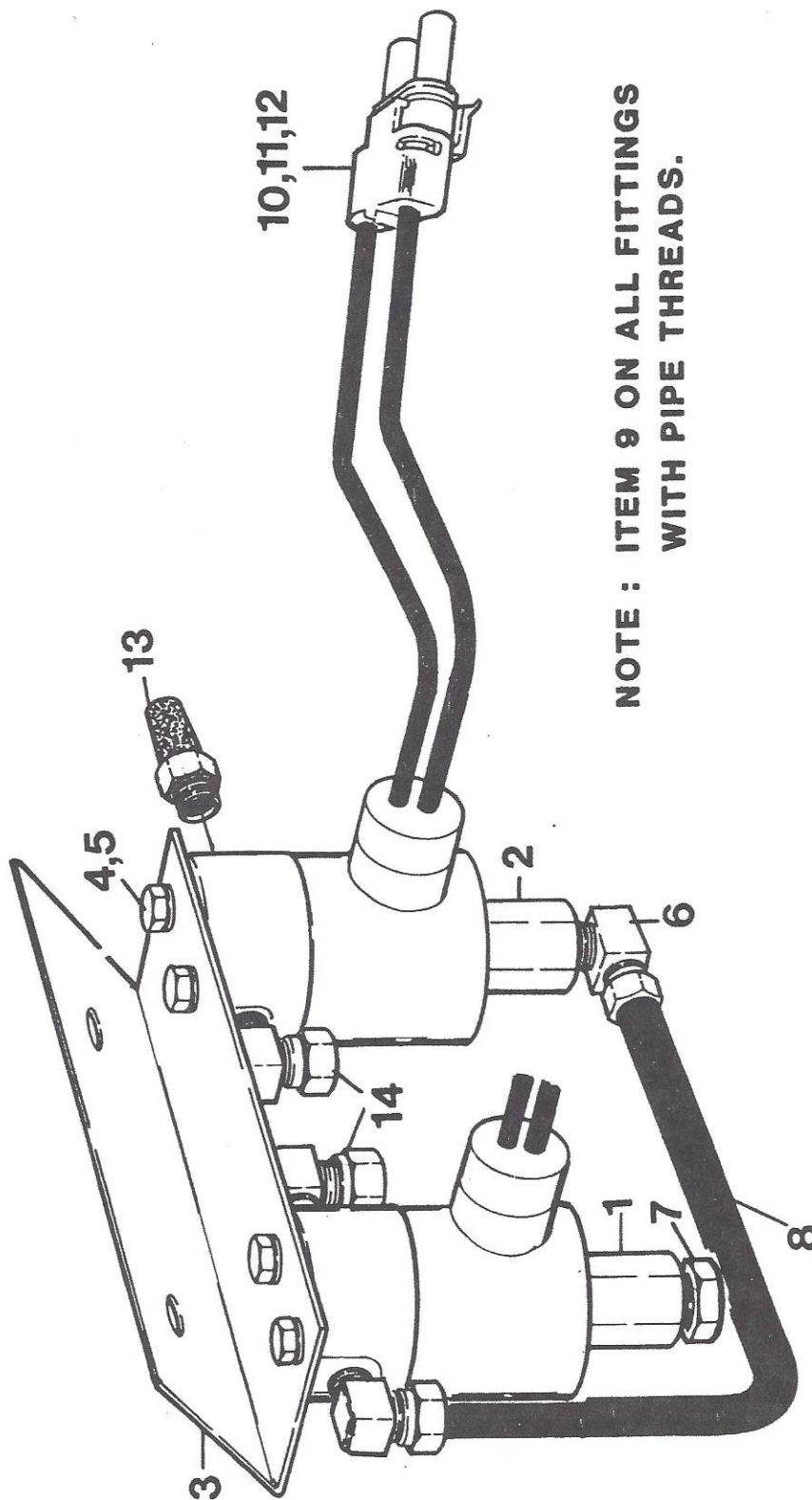

**NOTE : ITEM 9 ON ALL FITTINGS
WITH PIPE THREADS.**

Skinner Valves Assy. — Leveling System
Model 15

ITEM	PART NUMBER	DESCRIPTION	QTY.	
		Skinner Valves Assy. — Leveling System Model 15		
Ref.	159-1236-501	Skinner Valves Assy. - Leveling System M.H.O.		
1.	104-1292-514	Valve, Skinner	1	
2.	154-1236-006	Valve, 3-Way	1	
3.	109-1292-031	Bracket, Mounting	1	
4.	BS-4511-004	Washer, #10 Lock	4	
5.	BS-4163-603	Bolt, #10 x 3/8	4	
6.	BS-6891-201	Elbow, Male 90° 1/4" O.D. 1/8" NPT	2	
7.	BS-5213-171	Plug, 1/8	1	
8.	BS-2700-002	Tubing, Nylon	AR	
9.	BS-2575-109	Sealant, Teflon	AR	
10.	BS-5133-015	Connector, Tower	2	
11.	BS-5114-032	Pin, Terminal Male	4	
12.	BS-5115-015	Seal, Wire	4	
13.	154-1236-005	Muffler, Pneumatic Exhaust	1	
14.	BS-6891-301	Elbow, 90° Male	2	

MODEL 15 MHO SERIAL NUMBERS:
70096-FOWARD

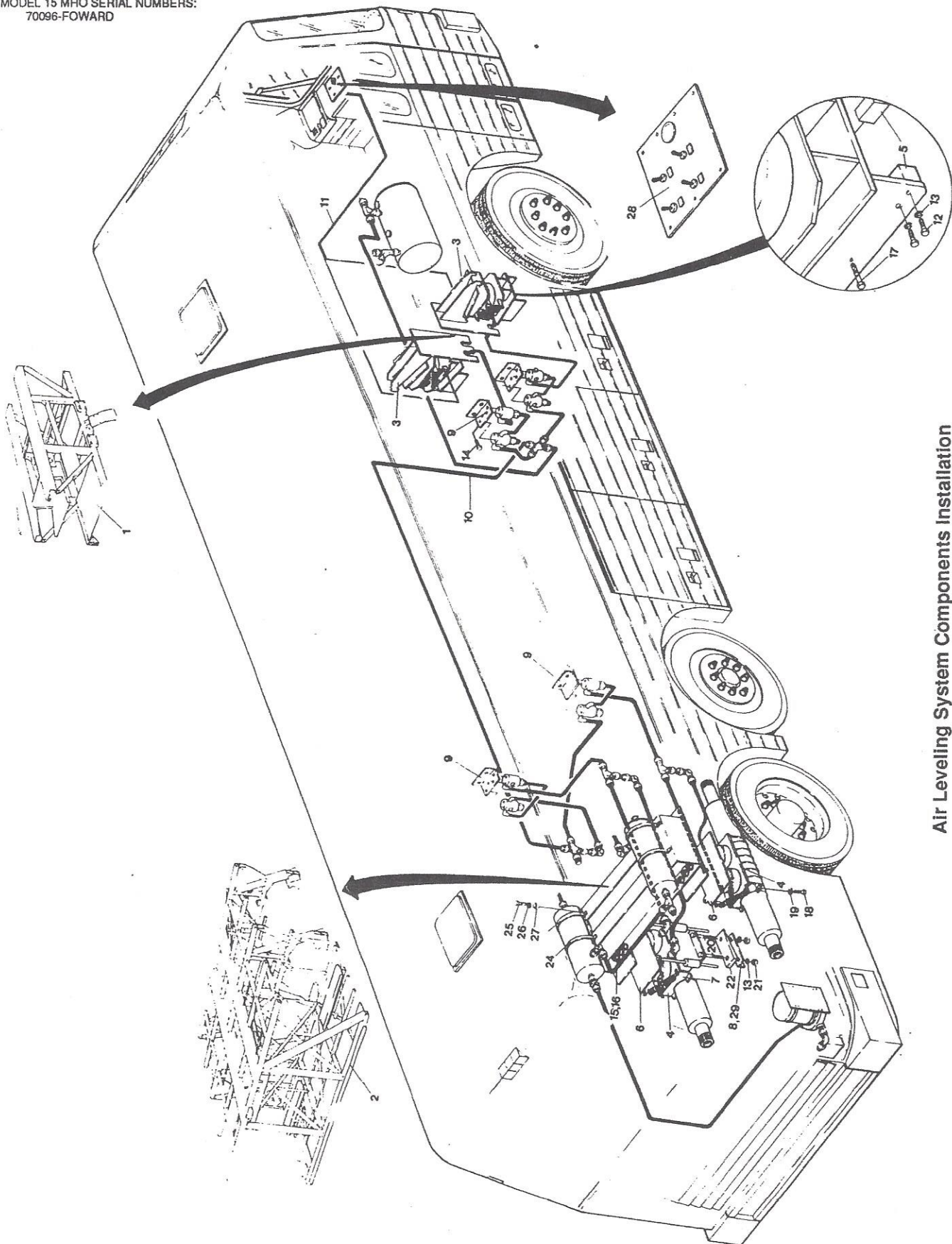

Air Leveling System Components Installation
Model 15

ITEM	PART NUMBER	DESCRIPTION	QTY.
Air Leveling System Components Installation Model 15			
Ref.	159-1236-500	Air Leveling System Complete Assembly	1
1.	159-1407-415	Frame Suspension Assembly (I.P.B. 14 - 305 - M.H.O.)	1
2.	159-1401-416	Main Chassis Leveling System (I.P.B. 14 - 310 - M.H.O.)	1
3.	159-0100-513	Front Suspension Leveling System (I.P.B. 01 - 100 - M.H.O.)	2
4.	159-0200-501	Drive Axle Air Bag Assembly (I.P.B. 02 - 100 - M.H.O.)	2
5.	159-0100-037	Block	4
6.	159-1465-195	Bottom Plate - (Drive Axle)	2
7.	159-0200-049	Clamp, Mounting L.H.	4
8.	159-0200-052	Bracket, Angle Mtg. L.H.	1
9.	159-1236-501	Skinner Valve Assembly (I.P.B. 12-116-M.H.O.)	4
10.	159-1221-512	Air System Layout-Leveling System (I.P.B. 12-020-MHO)	1
11.	159-1078-914	Electrical Harness Inst. (I.P.B. 10-100-M.H.O.)	1
12.	BS-4158-210	Bolt, Hex 3/8 - 16 UNC x 1.25 LG.	8
13.	BS-4511-008	Washer, 3/8 Lock	12
14.	BS-4199-101	Screw, Hex 1/4 - 14 x 1-00	8
15.	BS-4153-033	Screw, Flt. Hd. Socket 3/8 - 16 UNC X 1.25	16
16.	BS-4227-022	Nut, 3/8 - 16 UNC Lock	16
17.	BS-4158-253	Bolt, Hex 3/8 - 16 UNC x 8.50 LG.	2
18.	BS-4158-005	Bolt, Hex 1/4 - 20UNC x 5/8 LG.	8
19.	BS-4511-006	Washer, Lock 1/4"	8
20.	BS-4158-249	Bolt, Hex 3/8 - 16 UNC x 6.50 LG.	4
21.	BS-4202-103	Nut, Hex 3/8 - 16 UNC	14
22.	159-0200-062	Shim	1
23.	BS-4158-251	Bolt, Hex 3/8 - 16 UNC x 7.50 LG.	2
24.	159-0200-056	Strap, Reservoir	4
25.	BS-4158-108	Bolt, Hex 5/16 - 18 UNC	8
26.	BS-4511-007	Washer, 5/16 Lock	8
27.	BS-4202-102	Nut, Hex 5/16 - 18 UNC	8
28.	159-1626-900	Leveling System Controls (I.P.B. 10-110-M.H.O.)	1
29.	159-0200-407	Air Bag Mounting Bracket Assy. R.H.	1